

5.0 ACTION PLAN

This section identifies the performance targets and actions needed to fulfil the objectives for the Park management. Developed to address issues identified during preparation of the Plan of Management, these strategies or actions are consistent with the objectives, community values, desired outcomes, and the vision for the Park outlined previously in Section 3.

5.1 Landscape Master Plan

The Landscape Master Plan for Yarranabbe Park (Figure 5.1) illustrates the works and actions listed in the following Action Plan. These works are proposed to be implemented to achieve the community's objectives and desired outcomes for the Park.

5.1.1 Improvements and works

Improvements shown on the Master Plan and referenced in the action plan are listed below:

1. Public art to site entry
2. New access path to promenade
3. Community exercise stations
4. Ferry pavilion
5. Potential for ferry / water taxi use of public wharf
6. Seating wall to promenade
7. Under-prune existing vegetation to improve public safety
8. Potential swimming baths in netted enclosure
9. Potential swimming pontoon
10. New stair to access bay
11. Bathers pavilion & interpretive signage / public art
12. Seats to promenade
13. Widen existing promenade
14. Public art in new plaza area
15. Stairs to access bay
16. New pedestrian path
17. Create plaza area to terminate promenade, including new seating
18. Create tree protection zone to root zones of existing Figs
19. Remove 2 existing Figs, introduces rhythm to street trees and allows 90° parking
 - a. Remove parking on eastern side, provides no net loss of parking
 - b. Retain parking to eastern side, providing 16 additional spaces
20. Gateway artwork & planting, potential paving treatment to roundabout.
21. Create 90° parking bays, retain existing road width, 10 additional bays
22. New *Ficus rubiginosa* to complete street tree avenue
23. Shade structure to existing playground
24. Traffic calming thresholds

2012

1930's

The 1930's saw an intensification of use & development in the northern end of the Park. The reserve was to be levelled, and an enquiry as to the best use for the reserve held. The land was to "be utilised as a park as it is too narrow for sports".

However, Council minutes from 1932 note sports fields being used for hockey in the "Beach Road Reserve". There are also numerous proposals around this time, for sporting facilities including a golf practice range, tennis courts (two already existed near the baths), cricket wicket (although the area was thought too narrow), depot for sea cadet training, dressing sheds & shelters for hockey players, although it is unclear if any of the items were constructed.

Planting

In 1930 the Council minutes note that the Figs and Palms along New Beach Road were to be planted. Minutes from 1935 & 1936 note that plans were "submitted for the upgrade of the section of Beach Road Reserve north of the baths. With formal garden of trees, shrubs, rose gardens, turf, paths, seats, drinking fountains", and that the unmade section of Beach Road (north of Yarranabbe Road) be constructed.

A 1937 plan held by Council, shows simplified improvements, including figs along New Beach Road, hockey fields, tennis courts, dressing sheds. Later aerial photos (LPMA 2010) show remnants of the circular beds from this design.

Naval Use

Aerial photos, c1930, held in the State Library archives, show the Park & baths, with naval buildings restricted to the area now known as Sir David Martin Reserve. WWII saw the southern section of Yarranabbe Park being occupied by the Navy under emergency war-time powers. (WMC minutes).

1943 aerial photos (LPMA 2010) show the southern half of Yarranabbe Park, as being occupied by naval buildings with extensive buildings coverage of the site.

Minutes from the 1950's see ongoing discussion regarding the return of the leased navy land to Council as part of the Park, the land had been leased to the Navy since June 1931. The land was returned to Council during the late 1950's.

Park Name

It wasn't until 28th January 1972 that the name Yarranabbe Park was officially assigned to the Park by the Geographical Names Board. (GNB 2010). The name was considered to be the aboriginal name for Darling Point.

Olympic Regatta

The Park saw temporary use as the Olympic Sailing Shore Base, for Olympic regatta and test events between 1998 & 2000. The public jetty was reconstructed and the foreshore pathway upgraded as part of the agreement for these works. (WMC 2005).

2.4.3 Heritage Listings

Yarranabbe Park is not listed on any local or state heritage registers. However, there are a number of listed items in the locality. Sir David Martin Reserve to the south includes listed buildings, the bus shelter on New Beach Road is listed, as are a number of houses in the area.

2.4.4 Significant trees

Woollahra Council's register of significant trees (1992) lists trees throughout the municipal area, providing data on their species, significance, size, age and health. The trees along the Parks New Beach Road frontage are identified on the significant tree register.

Figure 5.1 Proposed Master Plan

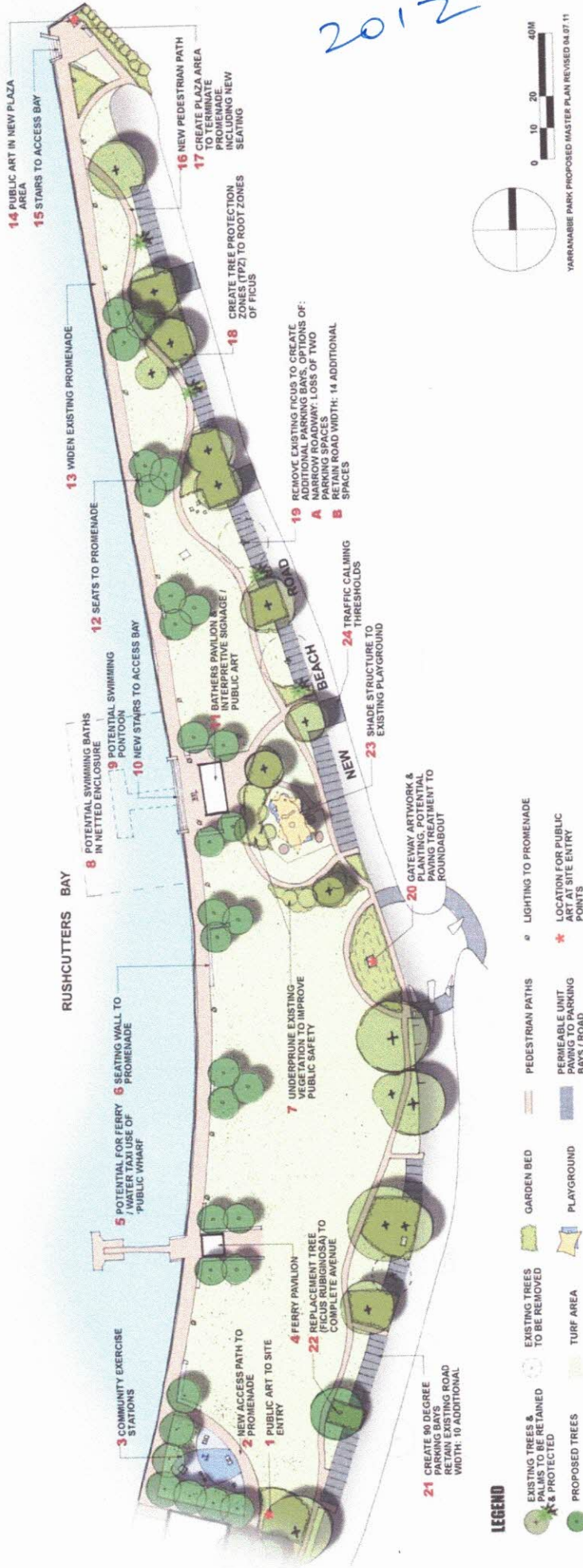

2012

Table 5.3 Value: Recreation

OBJECTIVE

To encourage, promote and facilitate recreational pursuits in the community, to provide for informal and passive recreational activities or pastimes and to promote and facilitate the Parks use to achieve the objectives for its management, and to ensure that such activities are managed having regard to any adverse impact on other users and adjoining land holders

PERFORMANCE TARGETS	MEANS TO ACHIEVE	PRIORITY	COSTS	ASSESSMENT OF PERFORMANCE
Provide for a range of passive activities in keeping with the Parks character	<ul style="list-style-type: none"> Allow a range of passive & informal recreation opportunities within the Park Prepare detailed designs & implement as funding allows 	High	-	<ul style="list-style-type: none"> Master Plan implemented
Provide areas for relaxing in groups or individually	<ul style="list-style-type: none"> Provide areas for groups or individuals 	Med	-	<ul style="list-style-type: none"> Detail designs prepared & implemented Master Plan implemented
Provide a variety of spaces and facilities to suit a range of groups and activities.	<ul style="list-style-type: none"> Prepare detailed designs & implement as funding allows Provide a range of spaces & facilities, implement as funding allows 	High	-	<ul style="list-style-type: none"> Detailed designs prepared & implemented Master Plan implemented, detailed designs prepared. Master Plan implemented
	<ul style="list-style-type: none"> Provide opportunity to access the water, for views, water based recreation 	High	\$750,000 in total	<ul style="list-style-type: none"> Master Plan implemented
	<ul style="list-style-type: none"> Investigate opportunities to provide swimming baths in netted enclosure (8) or swimming pontoon (9) 	Low		<ul style="list-style-type: none"> Report prepared, options investigated
	<ul style="list-style-type: none"> Investigate opportunities to provide launch areas for small craft/canoes 	Med		<ul style="list-style-type: none"> Report prepared, options investigated
	<ul style="list-style-type: none"> Prepare detailed designs & implement as funding allows 	Med		<ul style="list-style-type: none"> Detail designs prepared and implemented as funding allows Master Plan implemented, detailed designs prepared Detailed designs prepared Designs implemented
Provide a variety of spaces & facilities to suit all ages and abilities.	<ul style="list-style-type: none"> Provide for facilities to suit all ages & abilities 	Ongoing	-	<ul style="list-style-type: none"> Master Plan implemented, detailed designs prepared Detailed designs prepared Designs implemented
	<ul style="list-style-type: none"> Provide paths, facilities and site furniture that are accessible to all Plan upgrade of facilities, prepare detail designs & implement as funding allows 	Ongoing	-	
	<ul style="list-style-type: none"> Retain & manage the open grassed area within the Park. Retain open grassed areas for a variety of users, picnickers, informal ball games, children's play, off-leash dog exercise Carry out regular repairs and maintenance to achieve a high quality landscape, as required increase maintenance regime to accommodate user demands. Implement upgrade to improve grading & drainage, improve surface with re-turfing & subgrade preparation Investigate irrigation requirements & water supply Allocate resources & funding. 	Ongoing	-	<ul style="list-style-type: none"> Master Plan implemented Open grass area retained per the Master Plan Grass area maintained to high standard
Retain & manage the open grassed area		Med	\$100,000 in total	<ul style="list-style-type: none"> Upgrade of turf being undertaken
		High		<ul style="list-style-type: none"> Irrigation proposal prepared
		Med		<ul style="list-style-type: none"> Funding allocated

2012

PERFORMANCE TARGETS	MEANS TO ACHIEVE	PRIORITY	COSTS	ASSESSMENT OF PERFORMANCE
<p>Investigate opportunities for improvements to parking and traffic safety.</p>	<ul style="list-style-type: none"> ▪ Undertake traffic and parking study to determine best solution to traffic & parking issues in New Beach Road ▪ Assess safety of parking & pedestrians on New Beach Road ▪ Investigate opportunities for increased or realigned parking ▪ Develop detailed designs to include 90° parking (19 & 21) ▪ Define and formalise parking to meet Australian Standards, delineate vehicle circulation including emergency access points ▪ Provide accessible parking spaces at entry points and at playground ▪ Prepare detail designs to include traffic calming measures or thresholds to New Beach Road (24) ▪ Prepare detail designs & allocate funding ▪ Carry out regular patrols to police parking restrictions in New Beach Road 	<p>High High High High High High Med Med Ongoing</p>	<p>\$5,000 - - \$150,000 - - - \$60,000 - -</p>	<ul style="list-style-type: none"> ▪ Traffic study undertaken, findings reported ▪ Safety audit undertaken & presented ▪ Prepare detailed parking design ▪ Prepare detailed parking design ▪ Prepare detailed parking design ▪ Accessible parking spaces provided ▪ Detailed designs prepared ▪ Detail designs prepared & implemented ▪ Patrols in place, vehicles parked correctly

Ross

Draft Recreation Strategy

Table 2: Main passive recreation parks and community facilities

ID	Park name	Suburb	Council owned/ managed	Activities										
				Passive / informal					Play		Water based			Active
				picnic facilities	kick-about / green space	walking / cycling path	lookout	playground	basketball court	swimming enclosure	non-motorised boat launch area	non-motorised boat storage	sports field	outdoor fitness equipment
1	Cooper Park	Bellevue Hill	Yes	✓	✓	✓		✓					✓	
2	Lough Playing Fields	Bellevue Hill	Yes		✓								✓	
3	Bellevue Park	Bellevue Hill	Yes				✓	✓						
4	Cooper Park Community Hall	Bellevue Hill	Yes		✓			✓						
5	McKell Park	Darling Point	Yes	✓	✓	✓	✓							
6	Rushcutters Bay Park	Darling Point	Yes	✓	✓	✓		✓					✓	✓
7	Yarranabbe Park	Darling Point	Yes	✓	✓	✓					✓			✓
8	The Drill Hall, the Studio and Sail Loft	Darling Point	Yes											
9	Canonbury Cottage	Darling Point	Yes				✓							
10	Blackburn Gardens	Double Bay	Yes	✓			✓			✓				
11	Double Bay Beach	Double Bay	Yes		✓	✓				✓	✓			
12	Murry Rose Pool, Seven Shillings Beach	Double Bay	Yes	✓			✓			✓				
13	Steyne Park	Double Bay	Yes	✓	✓	✓		✓			✓	✓	✓	
14	The Bay Room	Double Bay	Yes											
15	Cross Street, Studio 1	Double Bay	Yes											
16	Trumper Park	Paddington	Yes	✓	✓	✓		✓					✓	
17	EJ Ward Paddington Community Centre	Paddington	Yes											
18	Lyne Park	Rose Bay	Yes	✓	✓	✓		✓	✓	✓	✓		✓	
19	Rose Bay Park	Rose Bay	Yes	✓		✓	✓	✓		✓	✓	✓		
20	Tingira Memorial Park	Rose Bay	Yes	✓						✓	✓	✓		
21	Woollahra Park/Ovals	Rose Bay	Yes		✓								✓	
22	Woollahra Golf Course	Rose Bay	Yes			✓								
23	Rose Bay Cottage	Rose Bay	Yes											
24	Christison Park	Vaucluse	Yes	✓	✓	✓	✓		✓				✓	✓
25	Hermitage Foreshore Reserve	Vaucluse	No	✓		✓	✓							
26	Lighthouse Reserve	Vaucluse	Yes	✓	✓	✓	✓							
27	Nielsen Park	Vaucluse	No	✓	✓	✓	✓			✓				
28	Parsley Bay Reserve	Vaucluse	Yes	✓	✓	✓		✓		✓	✓			
29	Signal Hill Reserve	Vaucluse	Yes	✓	✓	✓	✓							
30	Strickland House*	Vaucluse	No	✓	✓	✓	✓			✓				
31	Vaucluse Park*	Vaucluse	No	✓	✓	✓								
32	Camp Cove Beach	Watsons Bay	Yes			✓	✓			✓				
33	Gap Park	Watsons Bay	Yes	✓		✓	✓							
34	Green Point Reserve	Watsons Bay	No			✓	✓							
35	Robertson Park	Watsons Bay	Yes	✓	✓	✓		✓		✓	✓			
36	South Head Reserve	Watsons Bay	No	✓		✓	✓							
37	Holdsworth Community Centre	Woollahra	Yes		✓			✓						

* Formal gardens

Current active open spaces

Table 3: Active open spaces

ID	Sports Park	Area	Main Organised/ Booked Activity	Current winter usage [^]	Field Lighting and Standards
1	Cooper Park (1 x junior rectangular field, 1 x junior synthetic cricket wicket)	Bellevue Hill	» soccer » cricket » tennis*	Rarely booked in winter, but popular with dog walking	✗
2	Rushcutters Bay Park (1 x full size rectangular field, 1 x 3/4 size rectangular field, 1 x junior synthetic cricket wicket)	Darling Point	» soccer » rugby » cricket » kickball	20hrs per week (daylight hours only)	✗
3	Lough Playing Fields (2 x junior synthetic cricket wickets, 2 x 3/4 size rectangular fields, grass netball court)	Double Bay	» cricket » soccer » netball	27.5hrs (daylight hours only)	✗
4	Steyne Park (1 x 3/4 size rectangular field, 1 x synthetic cricket wicket)	Double Bay	» hockey » cricket	12hrs per week plus daily usage by Double Bay Public School	✗
5	Trumper Oval (1 x turf cricket wicket, 1 x full size oval field, 2 x cricket practice nets)	Paddington	» AFL » cricket » athletics » tennis*	37hrs per week	✓
6	Lyne Park (1 x full size rectangular field, 1 x half size rectangular field)	Rose Bay	» soccer » rugby » tennis*	30hrs per week	✓ (on full size field only)
7	Andrew Petrie Oval (1 x full size rectangular synthetic grass field)	Rose Bay	» rugby » soccer » American Football (Gridiron)	60hrs per week	✓
8	Woollahra Ovals (2&3) (1 x turf cricket wicket, 2 x full size rectangular fields, croquet greens)	Rose Bay	» rugby » cricket » touch football » croquet	37hrs per week	✓ (training only)
9	Christison Park (2 x full size rectangular field, 2 x junior rectangular fields, 2 x synthetic cricket wickets, 2 x netball/basketball hard multi-courts)	Vaucluse	» cricket » hockey » soccer » rugby » netball » basketball	15hrs per week	✓ (very limited, training only)
10	Woollahra Golf Course	Rose Bay	» golf		

* While the anecdotal popularity of tennis is noted, bookings are not managed by Council

[^] Usage data sourced from report to Finance, Community & Services Committee of 19 August 2019

- Camp Cove Beach, Watsons Bay
- Parsley Bay Swimming Enclosure, Vaucluse
- Murray Rose Pool, Double Bay
- Watsons Bay Baths, Watsons Bay
- » Managed by National Parks and Wildlife:
 - Shark Beach, Nielsen Park, Vaucluse

why not build these??

These Council managed beaches and swimming areas in the harbour are of critical importance to Woollahra's residents, as there are no public indoor or outdoor swimming centres in the LGA and the harbour pools and beaches provide wonderful recreational and social opportunities as well as relief and respite on hot days.

In terms of recreational opportunities, the LGA's harbour pools and beach allow residents and visitors to undertake a wide range of activities, such as swimming fishing, sailing, boating, sailboarding, stand up paddle boarding, kayaking, outrigger canoeing, dragon boating, scuba diving, snorkeling, etc.

Field lighting

The popular booking requests for the sports parks is for after school and work hours. With only four of the eight sports parks currently lit, these fields are already at full capacity and cannot cater for additional growth. Council officers have advised that requests from clubs for field usage need to be regularly declined due to the lack of availability. If the fields at other sports parks were lit to training standards, Council would be able to accommodate an additional 160+ hours of field/ oval usage (refer to below table for individual sports parks). Field usage increases are based on lit fields being available from 5:30-9:30pm, five days a week.

The increased usage would need to be managed and the resultant wear and tear of the fields addressed accordingly through increased maintenance. Clubs would also have to take into the increased costs of training due to lighting bills.

Table 4: Potential increased use due to field lighting

Christison Park	1 floodlight (25 lux) covering a small section of field 1	60hrs/week (over 4 fields)
Cooper Park	No	20hrs/week
Rushcutters Bay Park	No	20hrs/week
Lough Playing Fields	No	40hrs/week (over 2 fields)
Steyne Park	No	20hrs/week
Trumper Park	Yes	Nil
Lyne Park	Yes	Nil
Andrew Petrie Oval (synthetic oval)	Yes	Nil
Woollahra Park/Ovals (2&3)	Yes	Nil
Total		160 hours

Synthetic playing fields

The use of synthetic fields to reduce pressure and increase field capacity has been investigated by Council and others in Greater Sydney.

There are a number of benefits to the synthetic field at Andrew Petrie Oval, most notably the additional use. Since opening, the field has not closed due to wet weather, as the infill and drainage allows play 365 days per year. The durability of the surface has increased usage from 30 hours per week to over 60 hours per week (on particular weeks).

While an additional synthetic field in the LGA would benefit the sporting community, it is believed that proposed field lighting increases would be a more effective manner to increase sporting opportunities. Currently, all Council's active open spaces are freely accessible to the public, outside the allocated training hours.

In regard to the two above issues of field lighting and synthetic playing fields, Council's resolution of 19 August 2019 is noted:

- » A. THAT Council defer a decision on the installation of another artificial turf field for 24 months to allow for further investigation of Woollahra Oval including the following consideration:
 - i. re-certification of Woollahra Oval
 - ii. an increase in usage of the field in particular

Sports Park	Lighting	Potential use increase if lit
-------------	----------	-------------------------------

during school hours

- iii. further time to review the general wear and tear, usage and longevity.
- » B. THAT Christison Park be noted as a possible location for an artificial turf field depending on further investigation and planning.
- » C. THAT staff investigate sports lighting at existing sportsfields including Rushcutters Bay Park, Lough Playing Fields, Lower Cooper Park and Christison Park with the aim to increase the fields' usability.
- » D. THAT a further report be presented back to the Committee to include costing, proposed timing, consultation plan, funding options and planning considerations for the installation of sports lighting as per recommendation C.

Absence of home ground

Sporting clubs continue to express concern over the lack of a dedicated home ground with a club house, change room facilities and storage areas.

The only dedicated clubhouse facilities are at Andrew Petrie Oval and Woollahra Ovals 2-3, both of which are managed by the tenant rugby union clubs through respective leases with Council. There are essentially amenities blocks also at Trumper Park and Christison Park, containing basic change facilities, limited storage and toilets.

Traditionally and in other local government areas, clubs have a dedicated sports ground that they share with another code in the alternative season. However, in the Woollahra LGA, the multi-use and multi-purpose nature of each active open space makes it difficult to assign one or two codes to an individual space. The fact that many of these open spaces are regularly used for passive recreation activities also makes it difficult.

From a clubs point of view, the absence of a home ground means they are unable to attract sponsorship and raise funds through canteen sales. This, combined with the increasing costs of playing, insurance and decline of volunteers is placing financial pressure on some clubs.

Facility upgrades

Two thirds of community survey respondents rated the quality of Council's sports facilities as either "good" or "very good". Only 16.3% felt that Council should improve the quality of the sports facilities into the future.

Overall, the majority of sports clubs believed that the ancillary facilities were suitable for the needs of their users, but mentioned that they would like to see the quality improved. Change room facilities and seating were among the most common responses.

It was noted by several clubs that female membership numbers are increasing in traditionally male dominated sports such as rugby union, football (soccer), cricket and AFL. As such, state sporting associations require

Priority Table	
High	1-4 years
Medium	5-8 years
Low	9+ years

Table 6: Action plan

Action No.	Action	Priority	Responsibility	Indicative cost
1.0 Management				
1.1	Update Plans of Management for open spaces	High	Council	Internal resources
1.2	Undertake master plans (consistent with any relevant PoMs) for the following sites: <ul style="list-style-type: none"> - Lyne Park - Rushcutters Bay Park (including David Martin Reserve, Yarranabbe Park and the resident sailing/yacht clubs) - Christison Park - Lough Playing Fields and Cooper Park - Trumper Park 	High	Council	Rushcutters Bay Park - \$70,000 Lyne Park - \$60,000 Christison, Lough/Cooper and Trumper - \$50,000 each
1.3	Investigate increased access to public and private school facilities, in line with State Government objectives and principles	Medium	Council	Internal resource
1.4	Develop a local community directory on Council's webpage to assist in the promotion of active and passive open spaces	Medium	Council	Internal resources
1.5	Undertake user satisfaction surveys in both active and passive open spaces (every two years)	Medium (and Ongoing)	Council	Internal resources
1.6	Establish clear standards of service related to the provision of active open space facilities such as club houses, scoreboards and other ancillaries	Medium	Council	Internal resources
1.7	Continue the shared nature of open spaces (passive/active) to make the best possible use of the limited open space available across the LGA, with improvements to active spaces as indicated elsewhere in this Action Plan to increase their functionality for the delivery of organised sport by clubs	Ongoing	Council	Internal resources
1.8	Continue working with City of Sydney, Randwick and Waverley Councils and National Parks in a collaborative approach to provide a variety of recreation and sporting opportunities	Ongoing	Council	Internal resources
1.9	Increase promotion of accessible active recreation and fitness programs where appropriate	Ongoing	Council	Internal resources
1.10	Investigate feasibility of repurposing and/or renovating current facilities including the Fletcher Street Depot and Grafton Street carpark (Waverley LGA) to incorporate possible recreational facilities	Low	Council	Internal resources
1.11	Investigate recreational opportunities in all new community facilities and/or upgrades to street domain including the Knox Street, Wilberforce Car Park and Cross Street Car Park developments	High	Council	Internal resources
1.12	Pursue external sources of funding, such as grants and funding from other levels of government and the business community to improve recreation facilities and Council-run programs	Ongoing	Council	Internal resources
1.13	Use the data provided in the 2019 Woollahra Community Facilities Study when promoting and planning indoor recreation and fitness programs where appropriate	Ongoing	Council	Internal resources
1.14	When preparing future strategic open space plans, refer to the Greater Sydney Commission (Eastern City District) Sports Infrastructure Plan, a significant body of work that has been prepared by the Commission, in consultation with Woollahra Council and other councils in the district, which provides a strong foundation for future facility provision and participation in sport and active recreation in the district	Ongoing	Council	Internal resources
1.15	Investigate the possibility of including or facilitating community access to private clubs and private schools (to utilise their facilities for community recreational purposes) as a condition of development consent where possible, and also with agreements that are not associated with developments	Ongoing	Council	Internal resources

Action No.	Action	Priority	Responsibility	Indicative cost
2.0 Passive open space				
2.1	Development of youth spaces <ul style="list-style-type: none"> – continue to progress the development of a youth facility (skate park) in Rushcutters Bay consistent with that proposed by the draft Play Spaces Strategy and relevant Council resolutions – undertake a feasibility study for the development of a significant youth precinct at Lyne Park (or another appropriate site) providing complementary features to that proposed at Rushcutters Bay 	High	Council	\$1,151,800 (allocated in 2022/23 budget)
2.2	Increased ground (and barbecues and toilets in peak times) maintenance	High	Council	Internal resources
2.3	Install directional and informative signage at key points of interest and popular walking trails (including the Bondi to Manly walk)	High	Council	\$150,000 (over 2 years)
2.4	Investigate the possible increased use of the public golf course though the inclusion of designated pathways and use by community events	Medium	Council	Internal resources
2.5	Increased number of rubbish and recycling bins Continue to investigate ways to better manage waste through parks including: - the continued review of smart bins - continued rollout of larger capacity bins - education program targeting park users including recycling and waste reduction	Medium	Council	Internal resources and \$30,000 (over 2 years)
2.6	Promotion of less used passive open spaces	Medium	Council	Internal resources
2.7	Develop a Shade Policy to include: » Increase natural shade in passive open spaces especially around existing playgrounds that do not have shade structures » Investigate the feasibility of installing shade structures at playgrounds taking into consideration community consultation.	Medium	Council	Internal resources
2.8	As per Council's 2020 resolution, Council officers to liaise with their Waverley counterparts in regard the feasibility of undertaking a similar trial as Waverley's <i>Street Play Initiative</i> in Woollahra, giving priority to streets in the Paddington and Cooper Wards	Medium	Council	Internal resources
2.9	Investigate the possibility of additional water craft storage at appropriate sites across the LGA	Low	Council	Internal resources
2.10	Undertake the recommended actions of Woollahra Play (Play Space Strategy) once complete	Ongoing	Council	TBD
2.11	Undertake a review of dog regulations throughout the municipality	High	Council	Internal resources
2.12	Undertake a review of Council's Commercial Fitness Training Policy	High	Council	Internal resources
2.13	Investigate the land owned by Sydney Water surrounding the Vacluse Reservoir (Clairvaux Rd) for future public recreation uses	High	Council	TBD
2.14	Investigate the development of heritage walks with informative signage and the use of technology (such as QR codes with links to maps and further information) for greater user experience and interaction'.	Medium	Council	TBD
2.15	Further develop and promote all walking trails in the LGA	Ongoing	Council	TBD
2.16	Continue to explore the Paddington Greenway concept, ensuring the recreational opportunities are aligned with this Strategy	High	Council	TBD
3.0 Active open space				
3.1	Undertake an audit of existing sports field lighting and a feasibility study to identify costs, environmental impacts, benefits and locations of field lighting across the LGA	High	Council	\$60,000 - \$80,000 Sites identified as priorities include: » Christison Park » Cooper Park » Rushcutters Bay Park » Lough Playing Fields » Steyne Park
3.2	Design and construct increased sports field lighting at priority sites identified by the above action. Designs must consider the possible impact of such lighting on residents and the potential for objections	High	Council	» TBD

Action No.	Action	Priority	Responsibility	Indicative cost
4.4	Continue to progress the Yarranabbe Park - Northern Plaza upgrade including harbour stairs to allow better interaction with the harbour and a location to launch non-motorised vessels including kayaks and stand up paddleboards	High	Council	\$400,000+
4.5	Investigate further opportunities for dinghy storage facilities at areas where unauthorised storage is an issue (including Parsley Bay Reserve)	High	Council	TBD
4.6	Investigate wheelchair accessible options for Camp Cove and Parsley Bay Beach	High	Council	\$40,000
4.7	Provide improved facilities at our harbour beaches to support swimming and relaxation, including seating, showers and safety facilities	Medium	Council	TBD
4.8	Investigate temporary play facilities on beaches / foreshores	Medium	Council	TBD
4.9	Continue to investigate accessibility options for Murray Rose Pool (as outlined in the Redleaf and Blackburn Gardens Plan of Management)	Medium	Council	TBD
4.10	Continue to work with NSW Maritime, Sydney Water and internal Council teams to assist in the improvement of stormwater and pollution on beaches including the installation of informative and educational signage	High	Council	Internal resources

Active open space

Issue	Needs assessment	Future direction
Active open space		
Field lighting	<ul style="list-style-type: none"> » Site inspections (evidence of over-use) » Common response to club surveys » Council resolution of 19 August 2019: <ul style="list-style-type: none"> – C: that staff investigate sports lighting at existing sportsfields including Rushcutters Bay Park, Lough Playing Fields, Lower Cooper Park and Christison Park with the aim to increase the fields' usability 	<p>Undertake an audit and feasibility study for the provision of field lighting with a view to increasing these fields' ability to cater for increased use.</p> <p>Proposed sites for lighting increases include, but are not necessarily limited to:</p> <ul style="list-style-type: none"> » Christison Park » Cooper Park » Rushcutters Bay Park » Lough Playing Fields (including netball courts) » Steyne Park
Over-use of fields	<ul style="list-style-type: none"> » Site inspections (evidence of unauthorised use, especially during wet weather) » Club survey responses demonstrated active spaces showing wear and tear from high levels of use 	<ul style="list-style-type: none"> » Increased maintenance program on active spaces » Undertake field lighting developments as per above
Lack of female friendly facilities/storage	<ul style="list-style-type: none"> » Common response from club survey » Limited built infrastructure identified during site and facility inspections » Increased female participation in traditionally male-dominated sports 	<ul style="list-style-type: none"> » Undertake a detailed audit of existing buildings servicing active open spaces to develop a works schedule for their upgrade over time including: <ul style="list-style-type: none"> – the inclusion of female friendly facilities – increased storage options – general toilet/change room upgrades – access for people with a disability » Investigate low-impact storage options for sites with no such facilities
Inadequate change facilities	<ul style="list-style-type: none"> » Site inspections » Common response to club surveys 	As above, especially in regard to female sports (detailed audit and works schedule)
Lack of spectating facilities	Site inspections, club survey responses and Council officer feedback	Work with sports club at Woollahra Ovals 2 & 3 to develop adequate spectating facilities
Club assistance	Various responses to club survey	Increase the promotion of assistance/education available for key areas of operation such as volunteer management, financial management and accessing external funding
Bowls clubs	The currently un-used Paddo Bowls and the struggling Vaucluse Bowling Club facilities could possibly be better utilised, especially given the LGA's lack of open space	Continue discussions with Crown Lands regarding the future use/management of the sites