

39 ETHAM AVENUE

DP 110549  
B

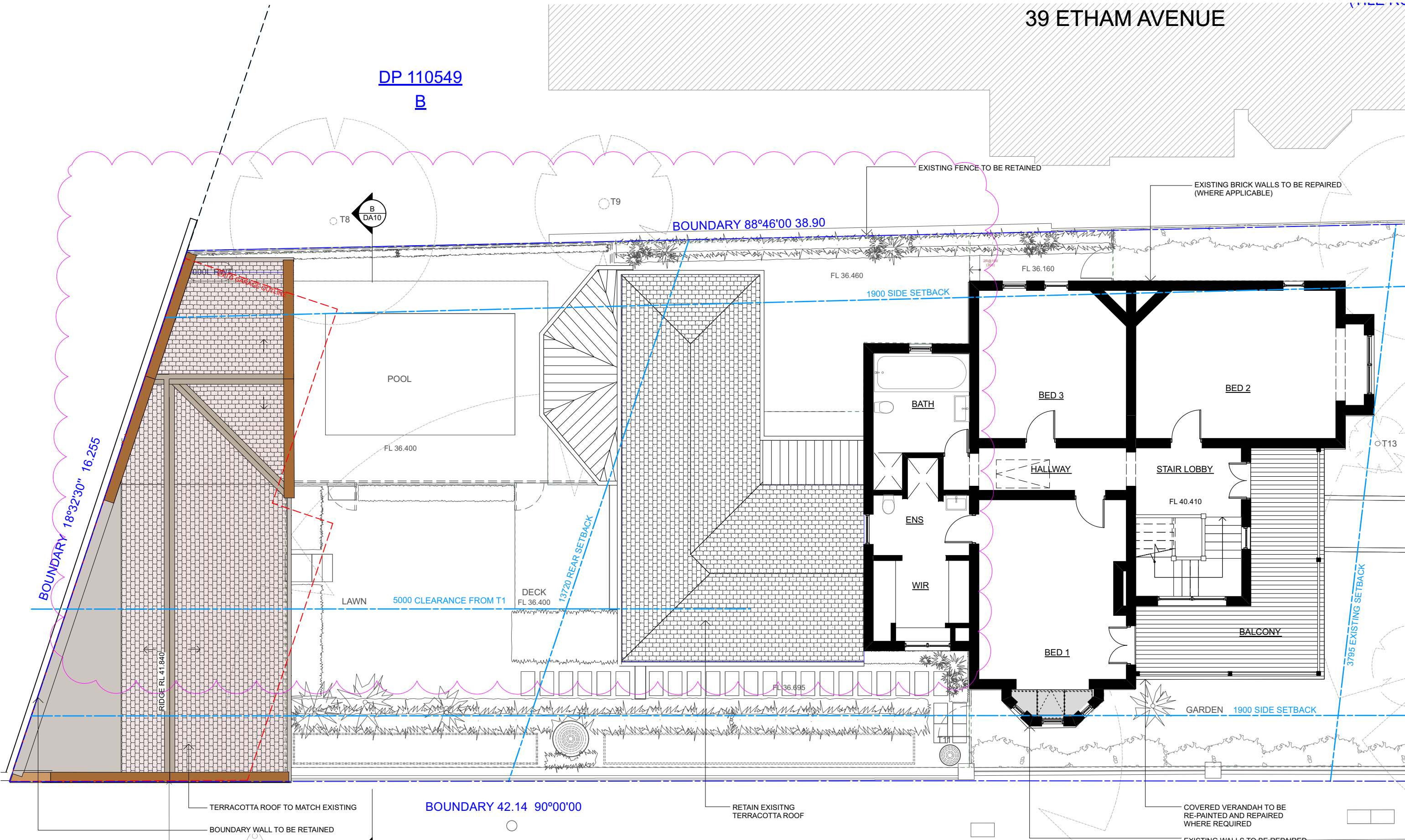

- KEY
- Existing
  - Proposed
  - Demolished
  - Site Boundary

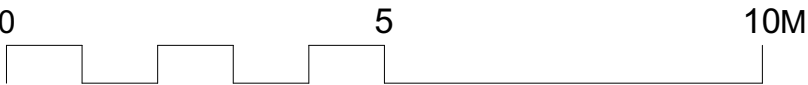
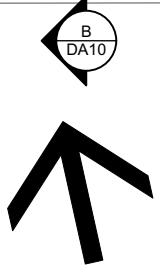

DO NOT SCALE DRAWINGS.  
CHECK ALL DIMENSIONS AND LEVELS ON SITE.  
REPORT DISCREPANCIES TO ARCHITECT PRIOR TO COMMENCING WORK.  
COPYRIGHT FOR THIS DESIGN RESIDES WITH THE ARCHITECTS.

ETHAM AVENUE

**Weir Phillips Architects**  
NSW Registration Number 6385 Robert Weir

C	22/6/22	ISSUE TO COURT	PROJECT #	LED
B	14/10/21	COUNCIL REQUEST FOR ADDITIONAL INFORMATION	CLIENT	Jacinta & David Lidbetter
A	15/9/21	DA SUBMISSION	DATE #	02/09/2021
ISSUE	DATE	REVISION	SCALE	1:100 @ A3
PROJECT	41 Etham Avenue, Darling Point		DWG #	DA03
DWG	Proposed First Floor Plan		DRAWN	JM
			CHKD	RW
			REVISION	C
Level 19, 100 William Street, Sydney NSW 2000				
T: 612 9310 1010 W: www.weirphillips.com.au E: info@weirphillips.com.au				